

CASTLE FRANK HIGH SCHOOL

ARCHITECTS – FLEURY ARTHUR & BARCLAY • PROJECT ARCHITECT – A. STERN • CONSULTING ENGINEERS – STRUCTURAL – MORRISON HERSHFIELD MILLMAN & HUGGINS LTD • MECHANICAL – R. T. TAMBLYN & PARTNERS LTD • ELECTRICAL – G. E. MULVEY & CO. LTD
GENERAL CONTRACTOR – BENNETT-PRATT LTD

Courses at this secondary school will offer training, below college entrance level, to prepare students for careers in the service industries. Shop training will be stressed with half of each day spent studying traditional academic subjects slanted in the direction of a particular career. Conditions which the student would find in business after graduation will be simulated in at least two areas. In the merchandising room students will be able to arrange displays and study various procedures including business methods. In the service station, exercises in practice will include office record keeping and window display techniques.

Special teaching facilities include: a library with insulated work spaces; a dark room that will accommodate a class; a green house organized as a teaching unit; four classrooms that can be adjusted into team teaching units by the removal of partitions. Storage for the many forms and documents used in classrooms will be located behind sliding chalkboards.

The swimming pool and its adjacent facilities have been designed for meets with seating for 500 people and will be available for summer classes for children in the district. Except for shops and the gymnasium and pool areas the school is fully air-conditioned.

House owners living on the periphery of the site objected to the school being built at all and so it will be located as far to the east as possible. A park of fine trees will separate the school from the residential area. Wherever possible significant trees were saved; in some cases the building was designed around, or in consideration of, specific trees.

Total floor area is 170,000 sq. ft, providing facilities for approx. 800 students at a cost of \$22.75 per sq. ft.

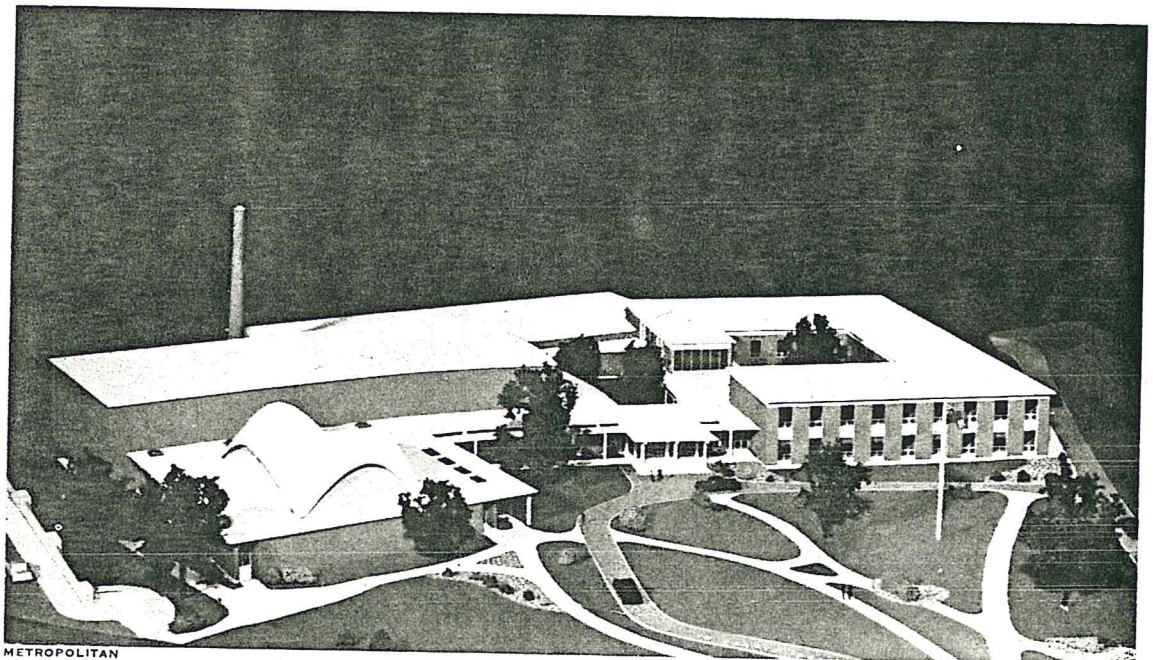

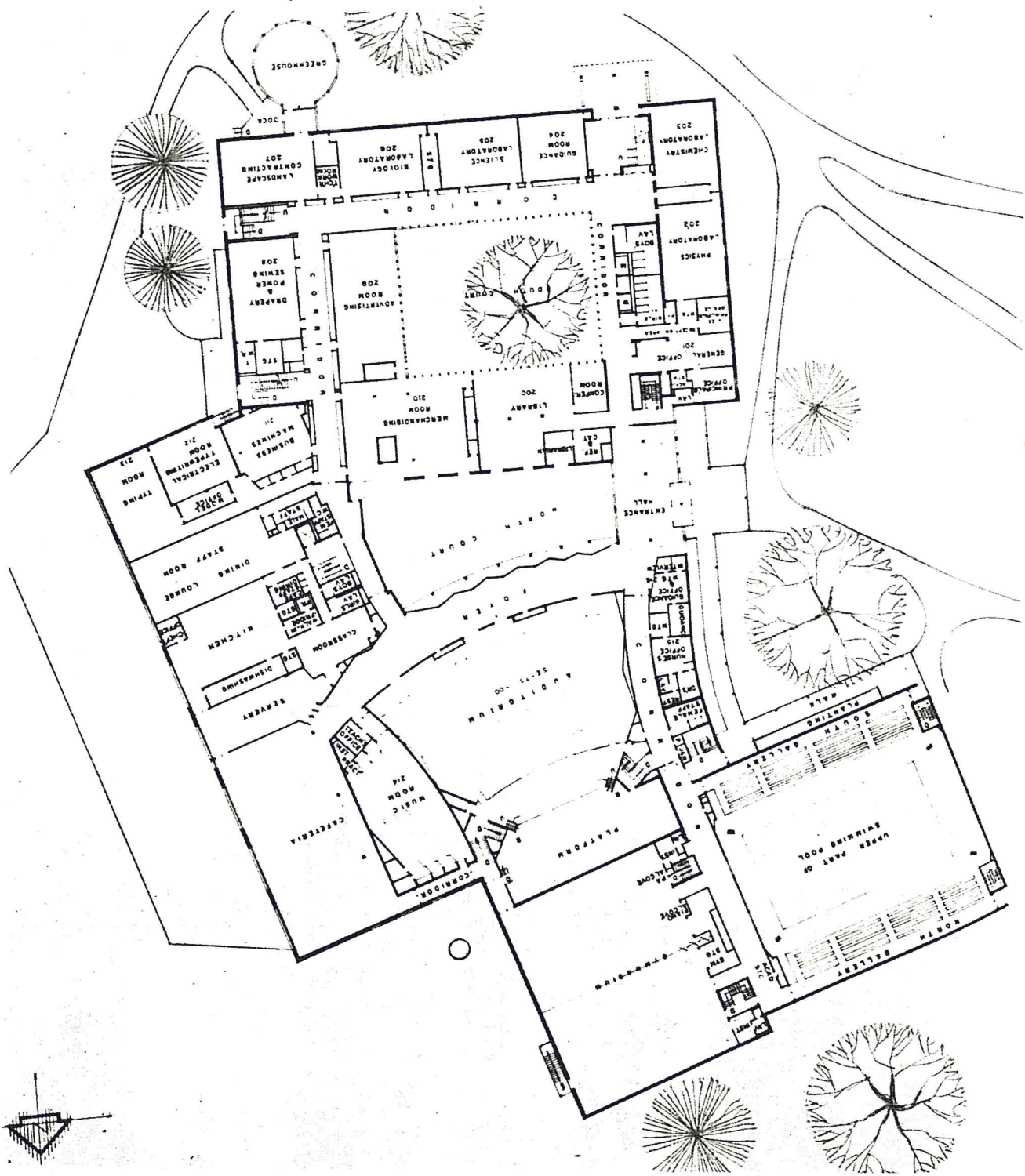

ULT-
ME-
LTD
trees
hemis
after
dis-
will
are a
units
hind
and
pool
ated
over
n of